

Vinyl Self Install Instructions

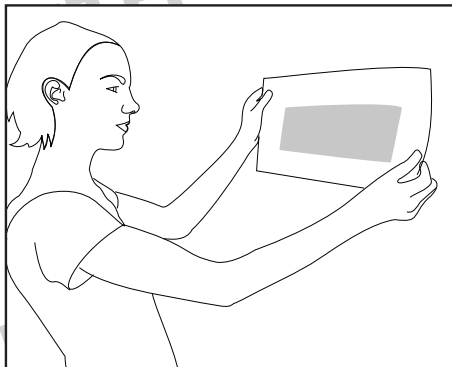

- Step 1 -

Prep the surface by cleaning it using soap, water, and a paper towel. If you're applying to glass, clean with windex.



- Step 2 -

Make sure the vinyl decal is level.

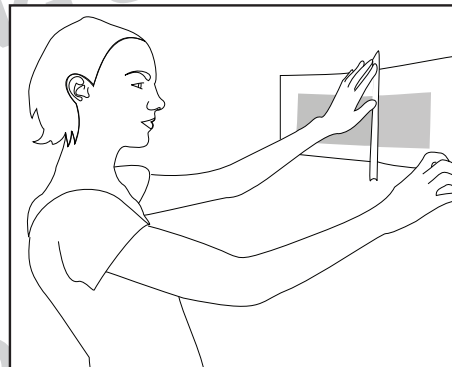

- Step 3 -

Secure the piece of vinyl to the wall by placing a strip of masking tape down the center of the decal.

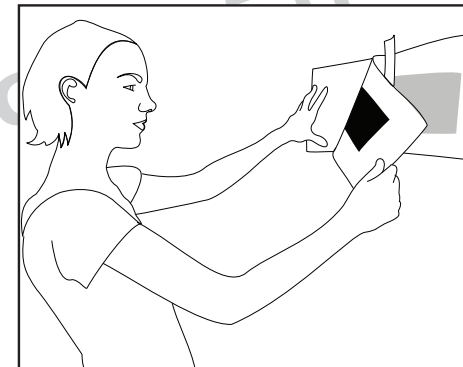

- Step 4 -

Peel the decal. Make sure that the vinyl is attached to the transfer tape.

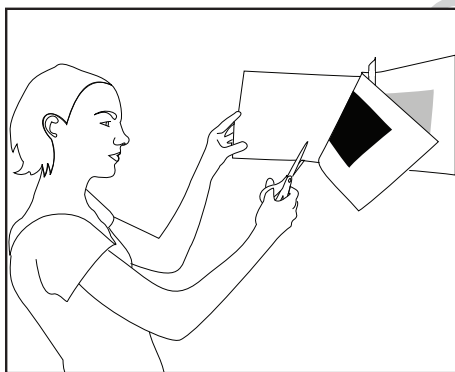

- Step 5 -

Cut off the wax paper backing.

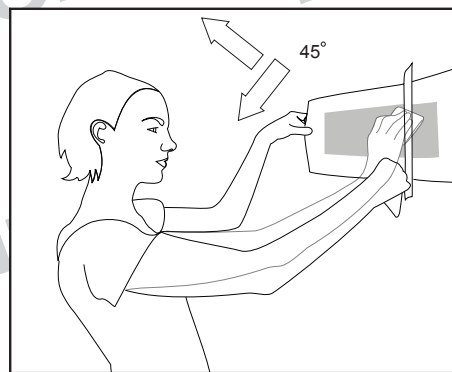

- Step 6 -

Using a squeegee, apply pressure using a smooth 45° up and down motion to apply the decal to the surface.

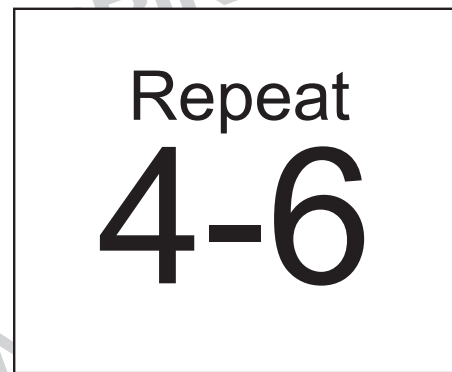

- Step 7 -

Take the masking tape off and then repeat steps 4 through 6 on the opposite side.

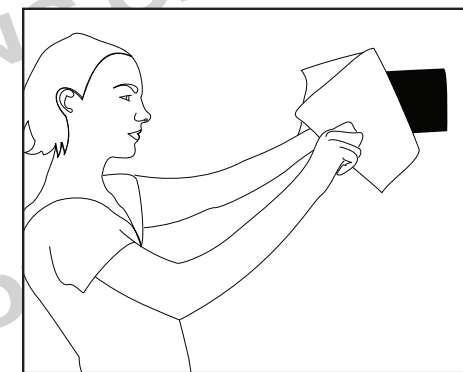

- Step 8 -

Slowly peel off the transfer tape at a 45° angle. Make sure that the decals are attached to the surface.